

CONSTRUCTION NOTES:

- PROJECT SCOPE**
1. INSTALL CONDUIT AND BASES AS SHOWN. TOTAL LENGTH OF SERVICE CABLE: 50m.
 2. INSTALL EQUIPMENT AS SHOWN.
 3. CROSSING TIME FOR NORTH CROSSWALK: 17 SECONDS, SOUTH CROSSWALK: 17 SECONDS.

- PROJECT COORDINATION**
1. COORDINATE WORK WITH SCOTT SUDERMAN, (204) 489-5900, scott.suderman@stantec.com.

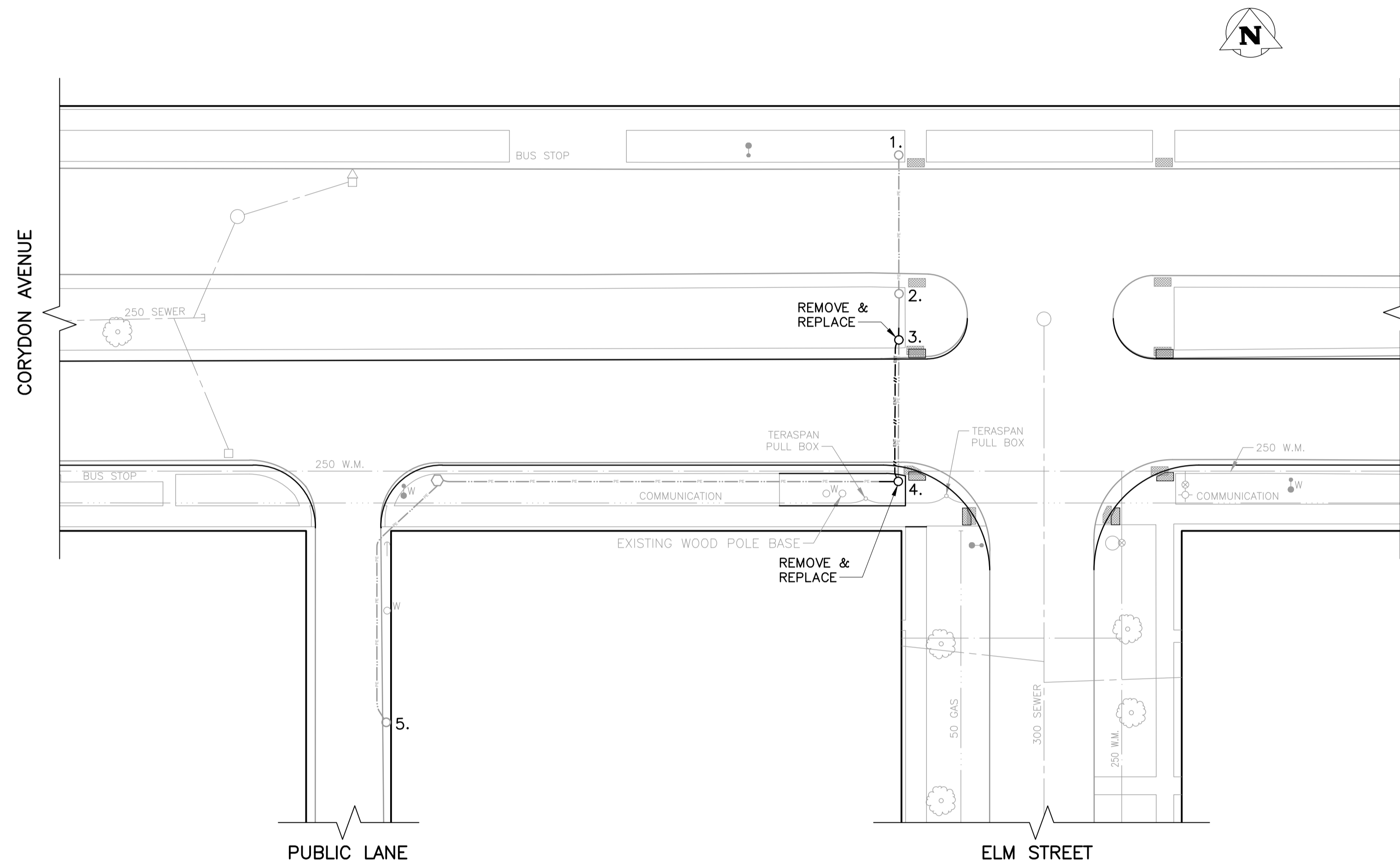

PLAN VIEW: UNDERGROUND CONSTRUCTION

1:250

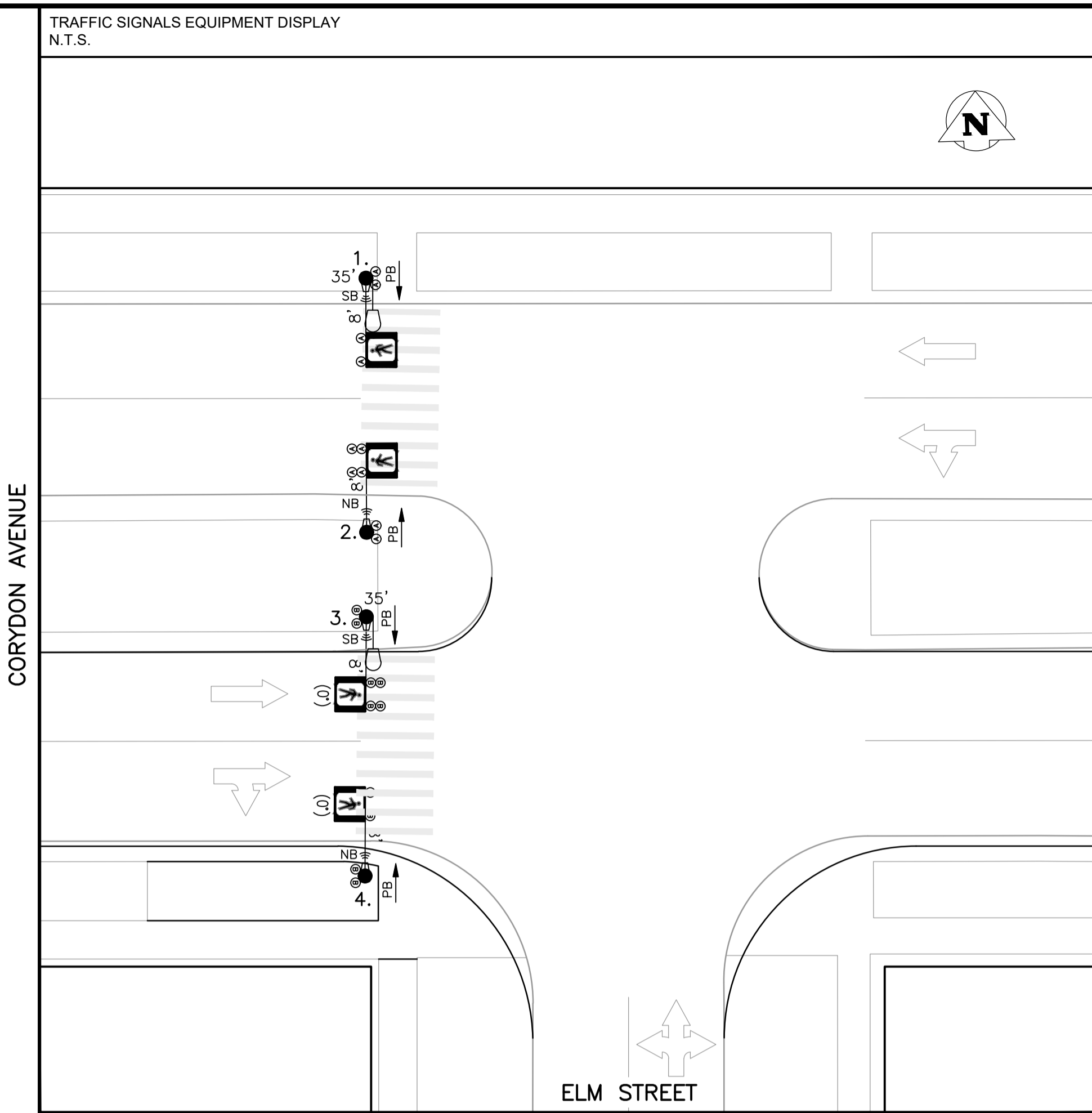

EQUIPMENT DISPLAY LEGEND

EXISTING		PROPOSED (AS SHOWN BELOW)	
	PEDESTRIAN HEAD		VEHICLE DETECTION AREA
	PEDESTRIAN HEAD WITH PCS		PUSH BUTTON & DIRECTION
	PEDESTRIAN CORRIDOR BOX		APS SINGLE DIRECTION
	TRAFFIC SIGNAL HEAD		TRAFFIC SIGNAL POLE
	RED FLASHER		AMBER FLASHER (CIRCUIT "A" OR "B")
	LUMINAIRE		CAMERA
	LOW ARM (SHOWN FROM CENTRE)		HIGH ARM (SHOWN FROM SIDE)

NO.	EQUIPMENT LIST	ARM	BASE	B.B.	NO.	EQUIPMENT LIST	ARM	BASE	B.B.
1.	35' SIGNAL FOR LUMINAIRE	8'	OD	DD					
2.	CANTILEVER	8'	OD	DC					
3.	35' SIGNAL FOR LUMINAIRE	8'	OD	DD					
4.	CANTILEVER	8'	OD	DC					
5.	HYDRO WOOD SERVICE								

EXISTING		PROPOSED (AS SHOWN BELOW)	
	1 1/2" PE CONDUIT		POLE BASE
	2" PE CONDUIT		CONTROLLER BASE
	2" ENT CONDUIT		PEDESTAL BASE
	AERIAL / BURIED CABLE		TERMINAL BASE
	CONDUIT STUB		SERVICE BOX (PIT)
	BREAK-IN		24" PRECAST PIT
	SPLICE		30" PRECAST PIT
	SAW-CUT LOOPS		36" PRECAST PIT
	PREFORMED LOOPS		REMOVAL

SIGNAL BASE BOLT SQUARE TYPES

BOLT SQUARE (B.S.)	DIA.
TYPE "A" - 8 1/8"	
TYPE "B" - 6 3/4"	
TYPE "C" - 8 1/8" SCREW TYPE	
TYPE "D" - 12 3/4", 1 1/4" DIA. BOLTS, 24" DIA.	
TYPE "OD" - 12 3/4", 1 1/4" DIA. BOLTS, 28" DIA.	
TYPE "PD" - 12 3/4", PRECAST, 1 1/4" DIA. BOLTS	
TYPE "E" - 9 9/16" SCREW TYPE	
TYPE "F" - 9 9/16"	
TYPE "G" - 8 1/8", 1 1/4" DIA. BOLTS, 89mm PROJ.	
TYPE "GS" - 8 1/8", 1 1/4" DIA. BOLTS, 76mm PROJ.	
TYPE "PG" - 8 1/8", PRECAST, 1 1/4" DIA. BOLTS	
TYPE "H" - 9 7/8" SCREW TYPE	
TYPE "I" - 7 3/4"	
TYPE "J" - 10 5/8", 1 1/4" DIA. BOLTS	
TYPE "K" - 10 5/8", PRECAST, 1 1/4" DIA. BOLTS	
TYPE "L" - 6", 5/8" DIA. BOLTS	
TYPE "PM" - 8 1/8", PRECAST, 5/8" DIA. BOLTS	

EXISTING	LEGEND	PROPOSED	EXISTING	LEGEND	PROPOSED	EXISTING	LEGEND	PROPOSED
	WATERMAIN			PROPERTY LINE			TELEPHONE	
	HYDRANT			ROADWAY			TELEPHONE	
	VALVE			SIDEWALK			WOOD POLE	
	SEWER			CURB & CURB RAMP			STREET LIGHT	
	MANHOLE			WARNING TILE			BANNER POLE	
	CATCH BASIN			SLOPE			RAILWAY POLE	
	CURB INLET			CULVERT			GUY-WIRE	
	HYDRO			BUILDING			FENCE	
	GAS			TREE			GUARDRAIL	

UNDERGROUND STRUCTURES

UNDERGROUND STRUCTURES ID	DATE (YYYY/MM/DD)

WATER & WASTE REVIEW ID

NOTE: LOCATIONS OF UNDERGROUND STRUCTURES AS SHOWN ARE BASED ON THE BEST INFORMATION AVAILABLE. BUT NO GUARANTEE IS GIVEN THAT ALL EXISTING UTILITIES ARE SHOWN OR THAT THE GIVEN LOCATIONS ARE EXACT. CONFIRMATION OF EXISTENCE AND EXACT LOCATION OF ALL SERVICES MUST BE OBTAINED FROM THE INDIVIDUAL UTILITIES BEFORE PROCEEDING WITH CONSTRUCTION.

CONSTRUCTION REVISIONS

NO.	REVISION	DATE (YYYY/MM/DD)	BY
0	ISSUED FOR UGS APPROVAL	2020/01/25	J.S.

ACCOUNTS:

PENDING

DESIGNED BY: J.S.

DRAWN BY: J.S.

CHECKED BY: C.H.

APPROVED BY: [Signature]

ENGINEER'S SEAL:

PRELIMINARY

NOT FOR CONSTRUCTION

THE CITY OF WINNIPEG

Winnipeg

PUBLIC WORKS DEPARTMENT

TRANSPORTATION DIVISION

PEDESTRIAN CORRIDOR

CORYDON AVE. & ELM ST.

DRAWING NUMBER: S-1982

UNITS: ALL DIMENSIONS ARE IN METERS UNLESS OTHERWISE NOTED